

SABELL METROPOLITAN DISTRICT

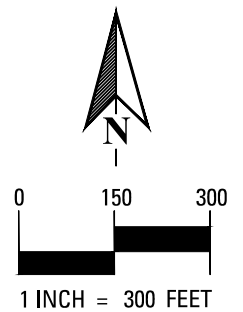
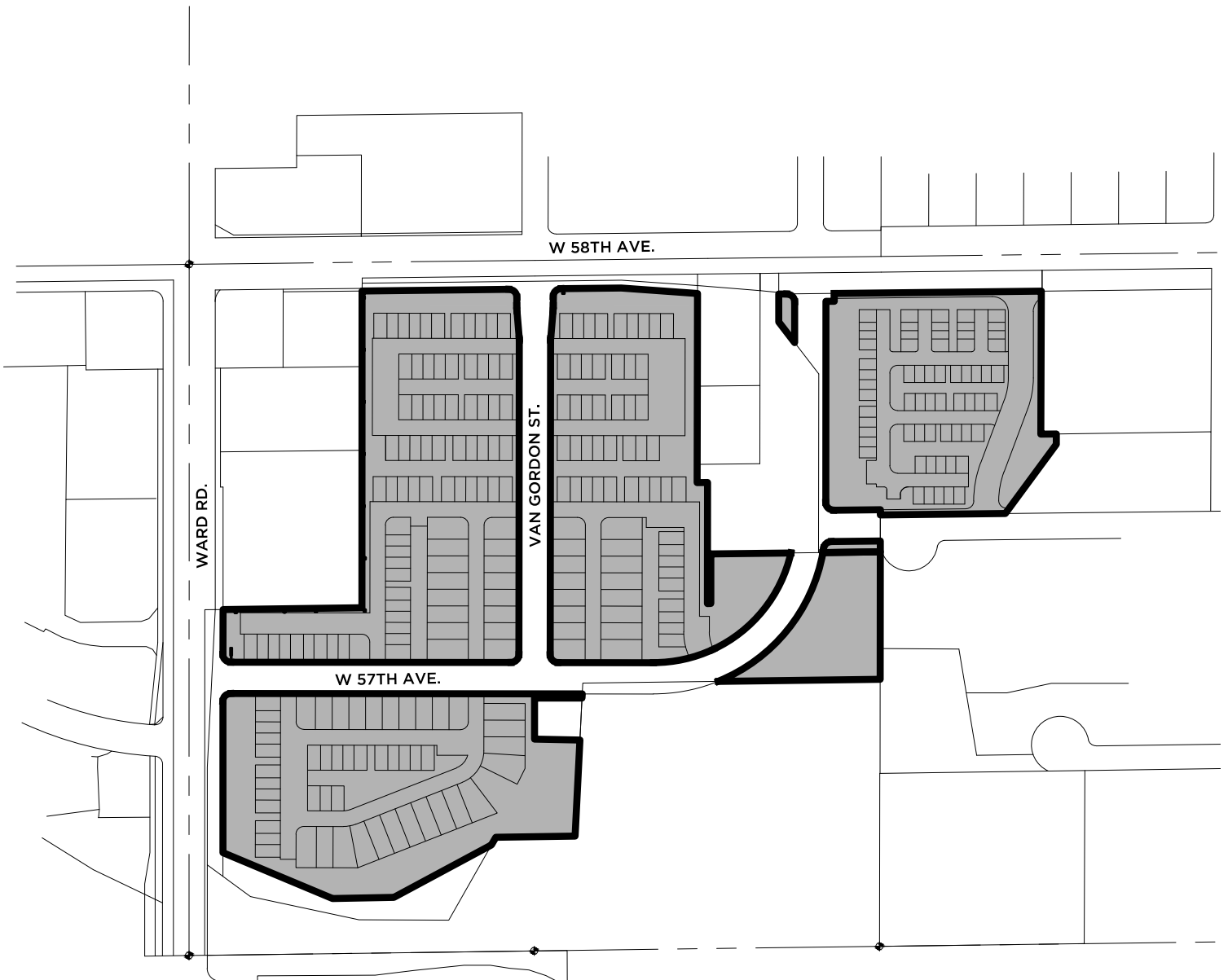

TITLE:
SABELL METROPOLITAN DISTRICT

LOCATION:
A PARCEL OF LAND LOCATED IN THE SOUTHEAST 1/4 OF SECTION 8,
TOWNSHIP 3 SOUTH, RANGE 69 WEST OF THE SIXTH PRINCIPAL MERIDIAN,
CITY OF ARVADA, COUNTY OF JEFFERSON, STATE OF COLORADO

SCALE: 1"=300'	DATE: 05-10-21	PROJECT NO.: 0009-1615	AREA:	PATH: J:\0009\1615\SURVEY\EXHIBITS\DISTRICT BOUNDARIES\SABELL_DISTRICT_OVERALL_EXHIBIT.DWG
--------------------------	--------------------------	----------------------------------	--------------	---



KT ENGINEERING

12500 W. 58th AVE. #230
ARVADA, CO 80002
PH: 720.638.5190